

# IBV – Indicating Butterfly Valve



## PRODUCT FEATURES

The Pratt Indicating Butterfly Valve (IBV) is a manually operated rubber seat Butterfly Valve with a high visibility target. The IBV is designed for indoor or vault/chamber service in Fire Protection Systems.

- Flanged IBV size range: 3" – 24"/DN80 – DN600, UL Listed 250psig/17barg.
- Conforms to AWWA C504 standards.
- Tested to UL 1091.
- Equipped with a weather proof Actuator.
- Does not require exercising.

## DIMENSIONS – inches (mm)

Valve Size	B	C	E	F
3"/DN80	3 <sup>3</sup> / <sub>4</sub> (95)	7 <sup>1</sup> / <sub>2</sub> (191)	1 <sup>3</sup> / <sub>16</sub> (21)	6 (152)
4"/DN100	4 <sup>1</sup> / <sub>2</sub> (114)	9 (229)	1 (25)	7 <sup>1</sup> / <sub>2</sub> (191)
6"/DN150	5 <sup>1</sup> / <sub>2</sub> (140)	11 (279)	1 <sup>1</sup> / <sub>16</sub> (27)	9 <sup>1</sup> / <sub>2</sub> (241)
8"/DN200	6 <sup>3</sup> / <sub>4</sub> (171)	13 <sup>1</sup> / <sub>2</sub> (343)	1 <sup>3</sup> / <sub>16</sub> (30)	11 <sup>3</sup> / <sub>4</sub> (298)
10"/DN250	9 <sup>7</sup> / <sub>8</sub> (251)	16 (406)	1 <sup>1</sup> / <sub>8</sub> (29)	14 <sup>1</sup> / <sub>4</sub> (362)
12"/DN300	11 <sup>3</sup> / <sub>8</sub> (289)	19 (483)	1 <sup>5</sup> / <sub>16</sub> (33)	17 (432)
14"/DN350	12 <sup>5</sup> / <sub>8</sub> (321)	21 (533)	1 <sup>7</sup> / <sub>16</sub> (36)	18 <sup>3</sup> / <sub>4</sub> (476)
16"/DN400	14 <sup>1</sup> / <sub>2</sub> (368)	23 <sup>1</sup> / <sub>2</sub> (597)	1 <sup>1</sup> / <sub>2</sub> (38)	21 <sup>1</sup> / <sub>4</sub> (540)
18"/DN450	15 <sup>1</sup> / <sub>4</sub> (387)	25 (635)	1 <sup>5</sup> / <sub>8</sub> (41)	22 <sup>3</sup> / <sub>4</sub> (578)
20"/DN500	17 (432)	27 <sup>1</sup> / <sub>2</sub> (698)	1 <sup>3</sup> / <sub>4</sub> (44)	25 (635)
24"/DN600	18 <sup>5</sup> / <sub>8</sub> (473)	32 (813)	1 <sup>7</sup> / <sub>8</sub> (48)	29 <sup>1</sup> / <sub>2</sub> (749)

Valve Size	# Holes – ØG	H	J	U	WT – lbs (kg)
3"/DN80	4 – 5/8 (16)	6 <sup>3</sup> / <sub>8</sub> (162)	7 <sup>3</sup> / <sub>8</sub> (187)	4 <sup>9</sup> / <sub>16</sub> (116)	45 (20)
4"/DN100	8 – 5/8 (16)	7 <sup>15</sup> / <sub>32</sub> (190)	7 <sup>3</sup> / <sub>8</sub> (187)	4 <sup>9</sup> / <sub>16</sub> (116)	90 (41)
6"/DN150	8 – 3/4 (19)	8 <sup>1</sup> / <sub>2</sub> (216)	7 <sup>3</sup> / <sub>8</sub> (187)	4 <sup>9</sup> / <sub>16</sub> (116)	115 (52)
8"/DN200	8 – 3/4 (19)	9 <sup>3</sup> / <sub>4</sub> (248)	7 <sup>3</sup> / <sub>8</sub> (187)	8 <sup>9</sup> / <sub>16</sub> (217)	150 (68)
10"/DN250	12 – 7/8 (22)	11 <sup>7</sup> / <sub>16</sub> (390)	7 <sup>21</sup> / <sub>32</sub> (194)	8 <sup>9</sup> / <sub>16</sub> (217)	260 (118)
12"/DN300	12 – 7/8 (22)	12 <sup>15</sup> / <sub>16</sub> (329)	7 <sup>21</sup> / <sub>32</sub> (194)	8 <sup>9</sup> / <sub>16</sub> (217)	320 (145)
14"/DN350	12 – 1 (25)	14 <sup>3</sup> / <sub>4</sub> (375)	7 <sup>21</sup> / <sub>32</sub> (194)	8 <sup>9</sup> / <sub>16</sub> (217)	405 (184)
16"/DN400	16 – 1 (25)	16 <sup>11</sup> / <sub>32</sub> (415)	9 <sup>7</sup> / <sub>8</sub> (251)	12 <sup>9</sup> / <sub>16</sub> (319)	500 (227)
18"/DN450	16 – 1 <sup>1</sup> / <sub>8</sub> (29)	17 <sup>7</sup> / <sub>32</sub> (437)	9 <sup>7</sup> / <sub>8</sub> (251)	12 <sup>9</sup> / <sub>16</sub> (319)	610 (277)
20"/DN500	20 – 1 <sup>1</sup> / <sub>8</sub> (29)	19 <sup>15</sup> / <sub>32</sub> (494)	11 <sup>5</sup> / <sub>32</sub> (283)	12 <sup>9</sup> / <sub>16</sub> (319)	850 (295)
24"/DN600	20 – 1 <sup>1</sup> / <sub>4</sub> (32)	23 <sup>3</sup> / <sub>16</sub> (592)	12 <sup>1</sup> / <sub>8</sub> (308)	12 <sup>9</sup> / <sub>16</sub> (319)	1285 (583)

G = No. & Size of Bolts. 125 lb. St'd. layout. All holes 1/8" (3mm) larger than bolt diameter except as noted. PN Drilling available on request.

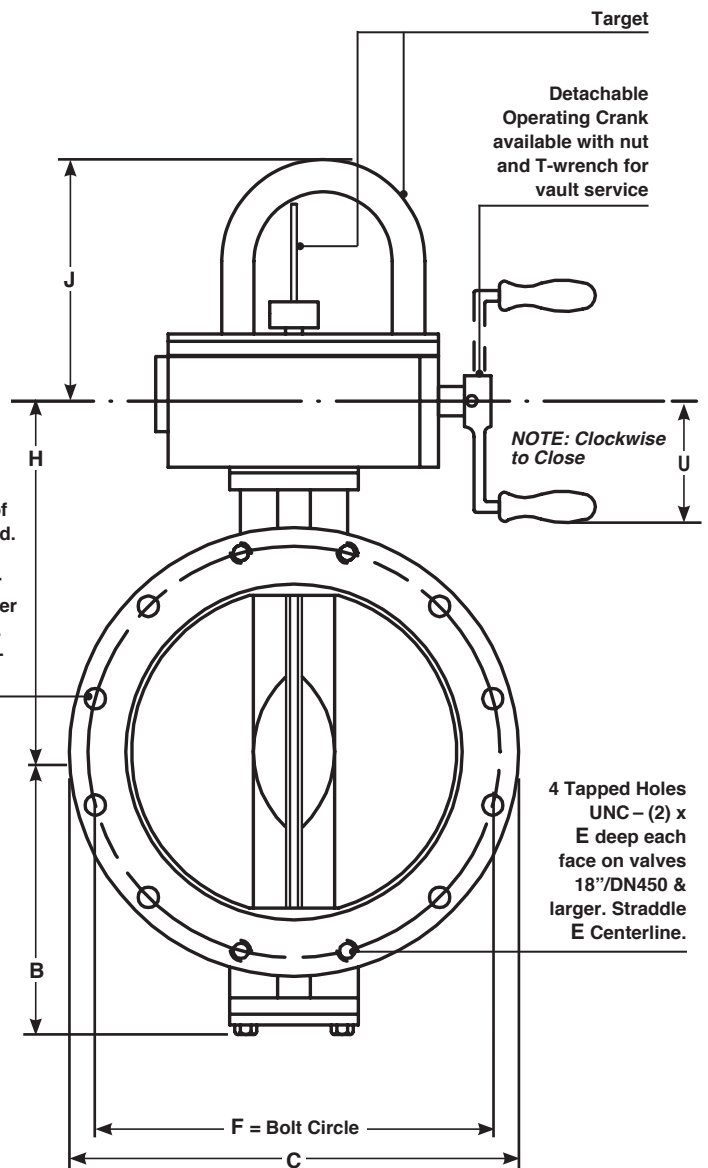

# IBV – Indicating Butterfly Valve

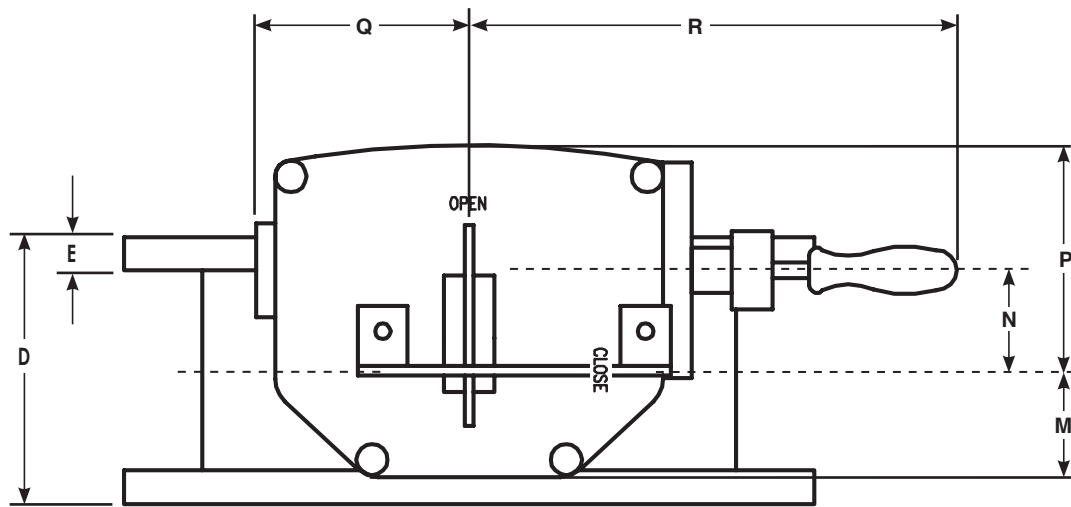

## DIMENSIONS – inches (mm)

Valve Size	D	E
3"/DN80	5 (127)	1 <sup>3</sup> / <sub>16</sub> (21)
4"/DN100	5 (127)	1 (25)
6"/DN150	5 (127)	1 <sup>1</sup> / <sub>16</sub> (27)
8"/DN200	6 (152)	1 <sup>3</sup> / <sub>16</sub> (30)
10"/DN250	8 (203)	1 <sup>1</sup> / <sub>8</sub> (29)
12"/DN300	8 (203)	1 <sup>5</sup> / <sub>16</sub> (33)
14"/DN350	8 (203)	1 <sup>7</sup> / <sub>16</sub> (36)
16"/DN400	8 (203)	1 <sup>1</sup> / <sub>2</sub> (38)
18"/DN450	8 (203)	1 <sup>5</sup> / <sub>8</sub> (41)
20"/DN500	8 (203)	1 <sup>3</sup> / <sub>4</sub> (44)
24"/DN600	8 (203)	1 <sup>7</sup> / <sub>8</sub> (48)

Valve Size	M	N	P	Q	R
3" – 6"/DN80 – DN200	2 <sup>1</sup> / <sub>8</sub> (54)	2 (51)	4 <sup>1</sup> / <sub>2</sub> (114)	4 <sup>1</sup> / <sub>2</sub> (114)	11 (279)
8"/DN200	2 <sup>1</sup> / <sub>8</sub> (54)	2 (51)	4 <sup>1</sup> / <sub>2</sub> (114)	4 <sup>1</sup> / <sub>2</sub> (114)	13 <sup>5</sup> / <sub>16</sub> (339)
10"–14"/DN250 – DN350	3 <sup>1</sup> / <sub>4</sub> (83)	3 <sup>5</sup> / <sub>32</sub> (80)	5 (143)	5 <sup>3</sup> / <sub>8</sub> (137)	15 <sup>7</sup> / <sub>16</sub> (392)
16"–18"/DN400 – DN450	3 <sup>3</sup> / <sub>8</sub> (86)	4 (102)	7 <sup>5</sup> / <sub>16</sub> (186)	6 <sup>3</sup> / <sub>4</sub> (171)	18 <sup>3</sup> / <sub>4</sub> (476)
20"/DN500	4 <sup>1</sup> / <sub>2</sub> (114)	5 <sup>1</sup> / <sub>2</sub> (140)	8 <sup>3</sup> / <sub>4</sub> (222)	10 <sup>1</sup> / <sub>8</sub> (257)	24 (610)
24"/DN600	5 <sup>1</sup> / <sub>2</sub> (140)	3 <sup>5</sup> / <sub>8</sub> (92)	10 <sup>1</sup> / <sub>2</sub> (265)	15 <sup>15</sup> / <sub>16</sub> (405)	26 <sup>7</sup> / <sub>8</sub> (683)

**NOTE: Dimensions +/- 1/16"**  
(1.5mm) up to 10"/DN250 valves,  
+/- 1/8" (3mm) for 12"/DN300 and  
larger valves.

## MATERIALS OF CONSTRUCTION

Part	Material
Body	Ductile Iron ASTM A536
Disc	Ductile Iron (3" & 4"/DN80 & DN100 CF8M)
Seat	EPDM or NBR
Shaft	Stainless Steel 17-4

## FLANGED CONNECTIONS

Pratt IBV valve bodies are available with Flanged connections. Underwriters Laboratories Listing for Flanged Valves is 250psig/17barg. Each Valve is tested for five minutes with air pressure against a closed disc covered in a pool of water at the pressure above rated pressure required by UL rules. Mechanical Joint end connections also available, please contact us for details.